

Featured Plan

The Archer



3,022-4199 SqFt plan features 4 Bedrooms, 4 1/2 Baths, a Bonus Room and Private Study. This plan features a spacious First Floor Master Bedroom with a Deluxe Bath and 2 large walk-in Closets. Entertaining spaces surround a 2-Story Great Room, finished with a fireplace and custom built-ins. A massive Gourmet Kitchen is complete with a pantry, breakfast bar and ample counter space and cabinets. The First Floor is finished with a Formal Dining Room and Study. The Second floor offers 3 Baths and 3 Bedrooms, all with walk-in closets. Completing the second level is a huge Bonus or Media Room. This custom home has a 3 Car Side Loading Garage and a First Floor Laundry Room. The Full Basement is perfect for storage or additional finished space.

WWW.RH-HOMES.COM

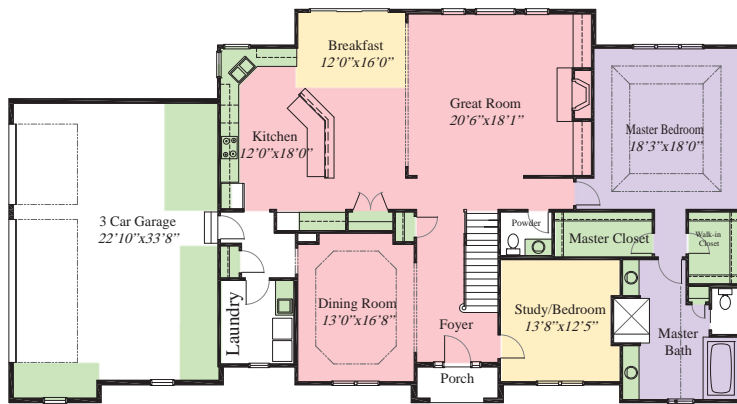

First Floor
2,356sq ft

- Entertainment Areas
- De-Stressing Zones
- Flexible Living Space
- Storage & DeCluttering Options

Second Floor

1,531 sq ft
1,078-1,531 sq ft
with Bonus Room

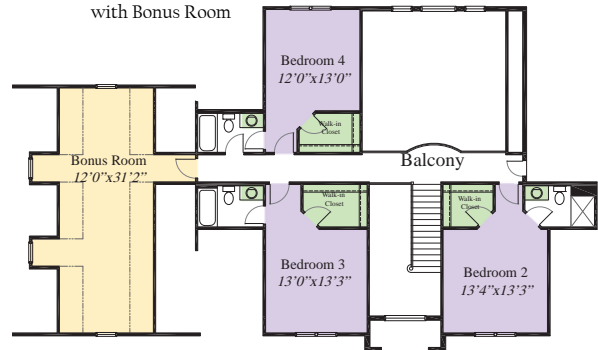

Total Living Space

3,887sq ft as shown



©Romanelli & Hughes Building Company – Custom Home Builders

All home plans present on this site/brochure are protected by copyright. Reproduction of these home plans, either in whole or in part, including any form and/or preparation of derivative works thereof, for any reason without prior written permission is strictly prohibited. Renderings, including landscaping, colors, materials and finishes are an artist's concept, and for aesthetic purposes only. This brochure is for illustration purposes and not part of any legal document. Request a set of blueprints for exact dimensions. The information on this brochure is subject to change without any notice.

Penalties for violating a copyright may be severe. The responsible parties are required to pay actual damages caused by the infringement (which may be substantial), plus any profits made by the infringer commissions to include all profits and from the sale of any home built from an infringing design. The copyright law also allows for the recovery of statutory damages, which may be as high as \$150,000.00 for each infringement. Finally, the infringer may be required to pay legal fees which often exceed the damages.