

Featured Plan

The Tisbury Reference L155

R & H
since 1970
ROMANELLI
&
HUGHES



1,700 SqFt Ranch home features 2 Bedrooms, 2 Baths, a Great Room with an 11' ceiling, a 3 car garage and a beautiful Gourmet Kitchen w/ access to a covered deck. The Private Study can be used as the 2nd Bedroom. The spacious Kitchen is open to the Dining Area and Great Room, which includes a beautiful fireplace. The Master Bedroom has a Deluxe Bath and a large walk-in closet. A separate Laundry Room is off the Garage access.

Olentangy Schools

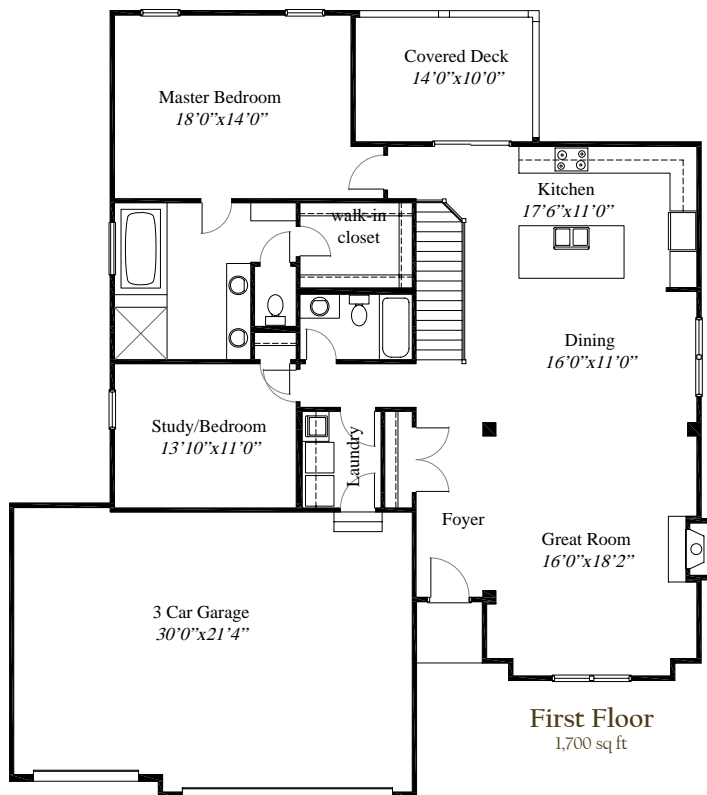

WWW.RH-HOMES.COM



The renderings in this brochure are an artist's concept of elevations from blueprints. The landscaping features, colors and textures are for aesthetic purposes only. Floor plans and sizes are subject to change without notice. Consult a set of blueprints for exact dimensions and details. Some of the features shown can be optional. This brochure is for illustration purposes only and is not part of any legal document.